

Model **260MRT** MINI ROUGH TERRAIN SCISSOR LIFT

Features

- 65 x 102 in. (1.65 x 2.59 m) Steel Platform
- 4 ft (1.22 m) Manual Roll-Out Deck Extension
- Fold-Down Platform Rails
- Moveable, Removable Platform Control Box
- Proportional Hydrostatic Drive Control with Thumb Steer
- Proportional Lift Up
- 110V-AC Receptacle in Platform
- Horn
- Hourmeter
- 3 Degree Slope Alarm and Light
- Lubrication-Free Scissor Arm Bushings
- Scissor Maintenance Prop
- Manual Descent Pull Cable
- Heavy Gauge Steel Chassis Hoods
- Nickel Plated Pins, Yellow Zinc-Chromate Plated Fasteners
- 26 x 12 in. Lug Tread Tires
- All Motion Alarm

Accessories & Options

- 26 x 12 Foam Filled Tires
- Platform Work Lights
- Full Swing-Gate
- 110V-AC Generator
- Flashing Beacon
- 33.5 lb (19.73 kg) Propane Tank
- Hydraulic Leveling Jacks



Exceptional mobility on or off slab

- Narrow 69-inch chassis fits into tight spaces
- Standard four-wheel drive with 35% gradeability

Larger work platform, high capacity

- Large 65 x 102 in. deck space with 4-foot roll-out deck extension
- 1,250-pound platform capacity and up to 300 lb on the platform extension

Service and reliability

- Simplified ground control wiring for ease of service
- Automatic transmission control and full diagnostics



Model 260MRT

MINI ROUGH TERRAIN SCISSOR LIFT

Specifications

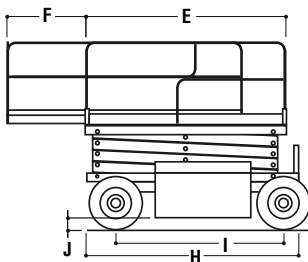
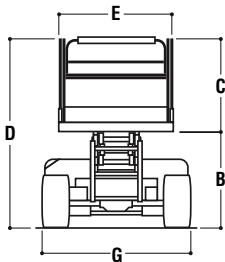
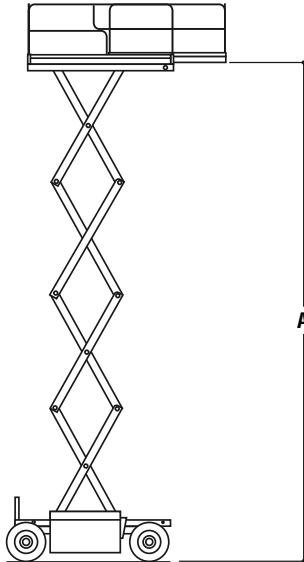

Dimensions

A. Platform Height Elevated	26 ft (7.92 m)
B. Platform Height Lowered	4 ft 1.5 in. (1.26 m)
C. Platform Railing Height	3 ft 7.5 in. (1.1 m)
D. Overall Height	7 ft 9.5 in. (2.37 m)
E. Platform Size	65 x 102 in. (1.65 x 2.59 m)
F. Platform Extension	4 ft (1.22 m)
G. Overall Width	5 ft 9 in. (1.75 m)
H. Overall Length (no outriggers)	8 ft 9 in. (2.67 m)
I. Wheelbase	6 ft 6 in. (1.98 m)
J. Ground Clearance	8 in. (20 cm)
Platform Capacity	1,250 lb (567 kg)
Capacity on Deck Extension	300 lb (136 kg)
Lift/Lower Speed	27/21 sec.
Maximum Drive Height	Full Height
Gross Vehicle Weight	7,360 lb (3,338 kg)

Chassis

Drive Speed-Lowered	3.5 mph (5.6 kmph)
Drive Speed-Elevated	0.4 mph (0.6 kmph)
Gradeability	35%
Turning Radius (inside)	84 in. (2.13 m)
Tire Size/Type	26 x 12 Lug Tread
Brakes	Spring Applied Hydraulically Released

Power system

Dual Fuel Engine	Kubota 24.5 hp (18.3 kW)
Diesel Engine	Kubota 26 hp (19.4 kW)
Fuel Tank Capacity	7.5 gal. (28.39 L)
Hydraulic Reservoir	15 gal. (56.78 L)



Standard Four-Wheel Drive for Terrainability



Strengthened Arm Stack for Improved Stack Rigidity

The JLG "1 & 5" Warranty

JLG Industries, Inc. backs our products with our exclusive "1 & 5" Warranty. We provide coverage on all products for one (1) full year, and cover all specified major structural components for five (5) full years. Due to continuous product improvements, we reserve the right to make specification and/or equipment changes without prior notification. This machine meets or exceeds applicable OSHA Regulations in 29 CFR 1910.67, 29 CFR 1926.453 and ANSI A92.6-1999 as originally manufactured for intended applications.



JLG Industries, Inc.
1 JLG Drive
McConnellsburg, PA 17233-9533
Telephone 717-485-5161
Toll-free in US 877-JLG-LIFT
Fax 717-485-6417
www.jlg.com

Form No.: SS-260MRT-100-60M
Part No.: 3131404
R060507
Printed in USA